

PK-35A29WQ/35N29WQ

PF-35N29WQ

PL-35N29WQ

INDIC.AUDIO P.ZO FL PK-35A29WQ

Serie:PK; PF; PL

p/n:PK-35A29W-Q

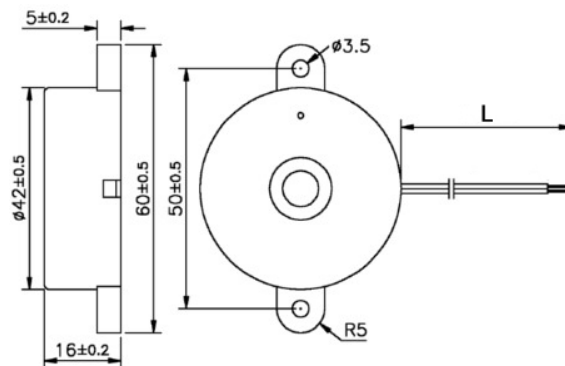

| Codice | Freq. di risonanza (Hz) ± 500 | Tensione di lavoro (V) | Min. livello sonoro (dB) @ 30cm | Tono | Assorbimento (mA) max. | L |
|--------------|-------------------------------|------------------------|---------------------------------|----------------------|------------------------|-----|
| 05640 | 2900 | 3.0 ÷ 24 | 95 @ 12V DC | Costante | 10 @ 12V DC | 140 |
| 05610 | 2900 | 3.0 ÷ 28 | 90 @ 12V DC | Costante | 10 @ 12V DC | 140 |
| 05615 | 2900 | 3.0 ÷ 28 | 90 @ 12V DC | Costante | 10 @ 12V DC | 400 |
| 05620 | 2900 | 3.0 ÷ 28 | 90 @ 12V DC | Fast pulse 3.0 Hz | 8 @ 12V DC | 140 |
| 05630 | 2900 | 3.0 ÷ 28 | 90 @ 12V DC | Slow pulse 1.2 Hz | 8 @ 12V DC | 140 |